

VACANT RETAIL SPACE

4424 CORUNNA RD FLINT, MI 48532



FOR LEASE

2,150 SQUARE FEET AVAILABLE



PROPERTY FEATURES:

- Available Space: 2,150 SF
- Zoning: Mixed Use (MU) This versatile zoning allows for a wide range of retail and commercial uses.
- Convenience stores, Offices, Medical and dental practices, Takeout Restaurants, Drug Stores, Banking Services, Veterinary clinics and more!
- Situated in the heart of a dense retail corridor
- Surrounded by credit retailers like Sam's Club, Walmart, Verizon, PPG Paints, Home Depot, Aldi, Kroger, Dollar General, and more
- Proximity to residential areas ensures a steady flow of recurring customer base.
- Parking: 34 spaces available for the entire property
- Leasing Ask Price: \$9+4.00NNN

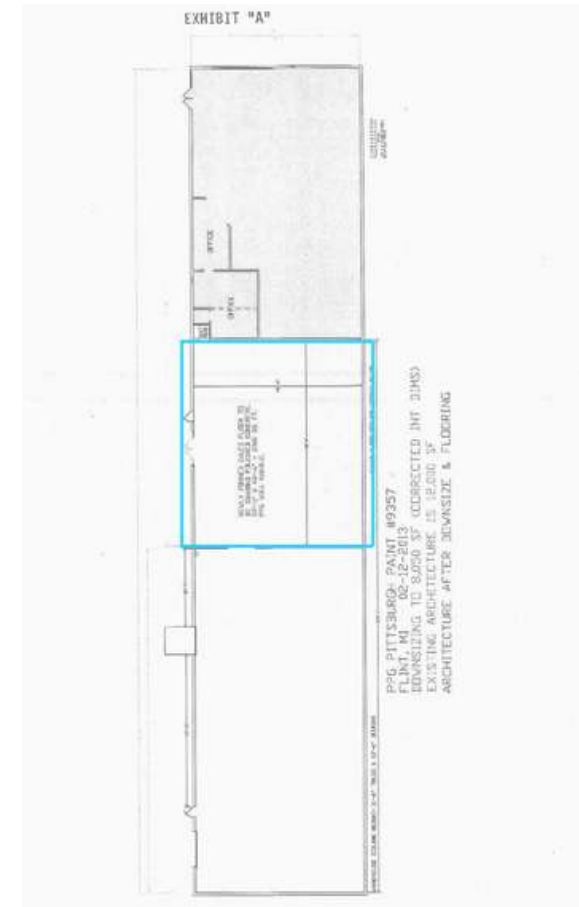

THE PROPERTIES THAT DEFINE YOUR BUSINESS, ARE OUR BUSINESS.

PROPERTY PHOTOS



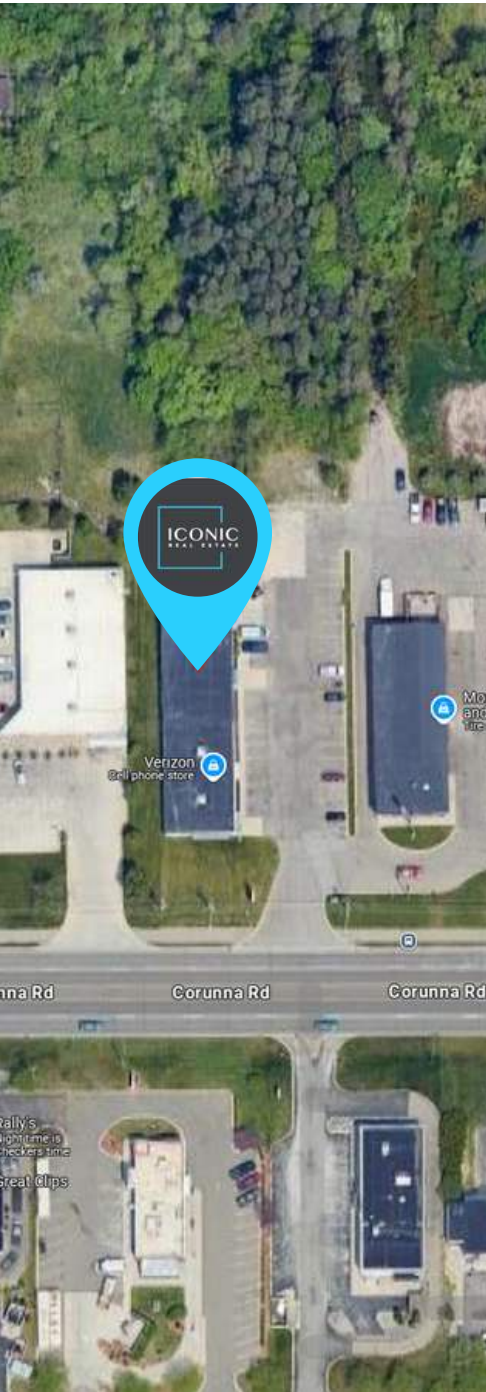



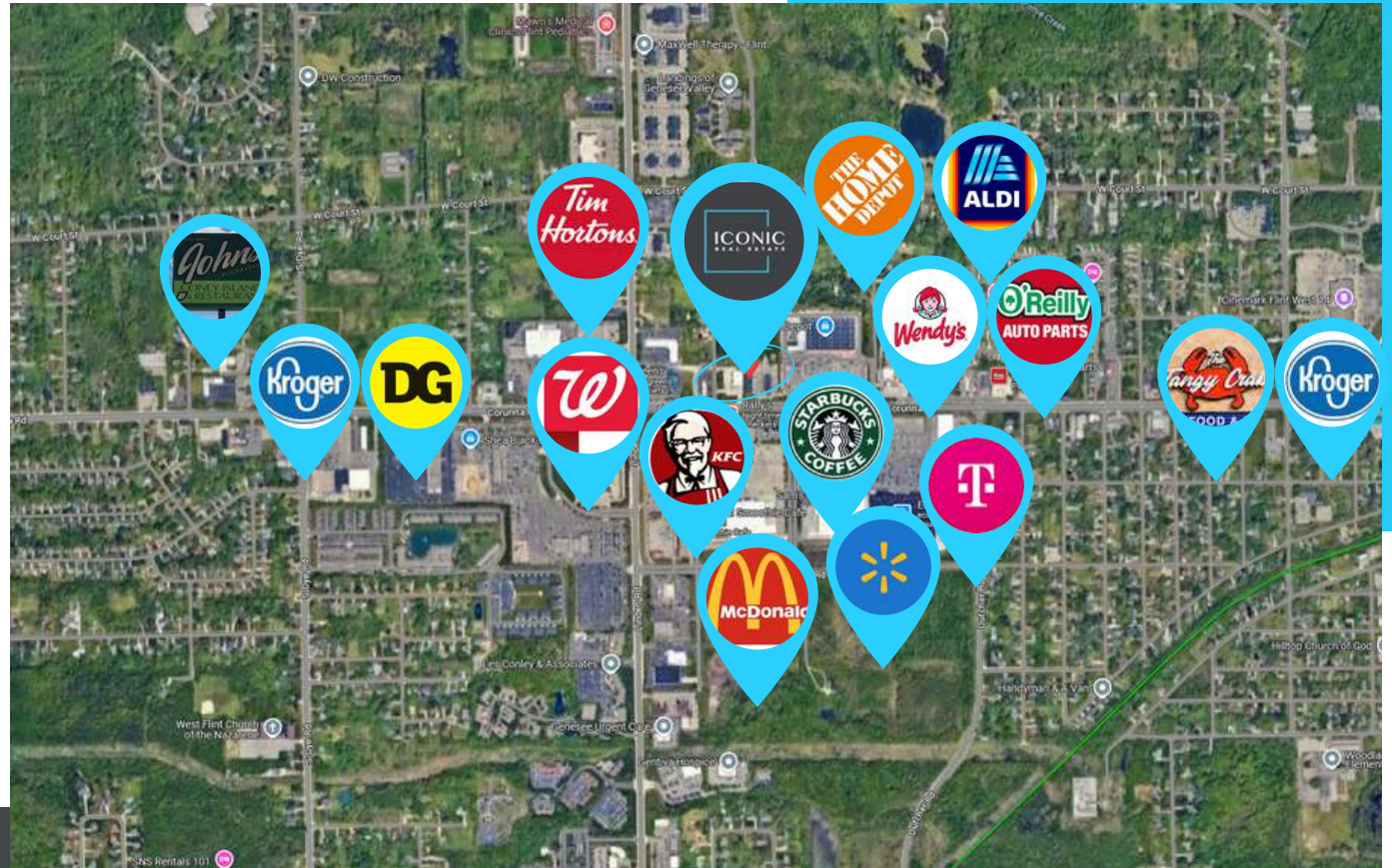

313-603-ICON (4266)



Contact Us

-  Broker
 Petar Elieff
-  Email
pelieff@ICONICdet.com
-  Website
www.iconicrealestate.com
-  Address
 300 E. Long Lake Road, Ste. 280
 Bloomfield Hills, MI 48304

WHY ICONIC?

Detroit is our home, and we know how to find the right space for your business to thrive. With **ICONIC**, you get local expertise and a perfect fit for your brand. Let us turn your vision into reality—because the right location makes all the difference.

DEMOGRAPHICS

DISTANCE	2 MILE	5 MILE
POPULATION	16,981	101,787
AVERAGE AGE	40.5	40.5
HOUSEHOLDS	7,448	45,813
HH INCOME	\$59,556	\$55,459

TRAFFIC COUNTS

CORUNNA RD	14,549
LINDEN	11,721

